

Please be aware that total weight of the sash and blinds mounted on the sash is not allowed to exceed the maximum sash weight for the specific opening function according to VELFAC web page.

Vær opmærksom på, at den samlede vægt af ramme og persienne monteret på rammen ikke må overstige den maksimale rammevægt for den specifikke åbnefunktion i følge VELFACs webside.

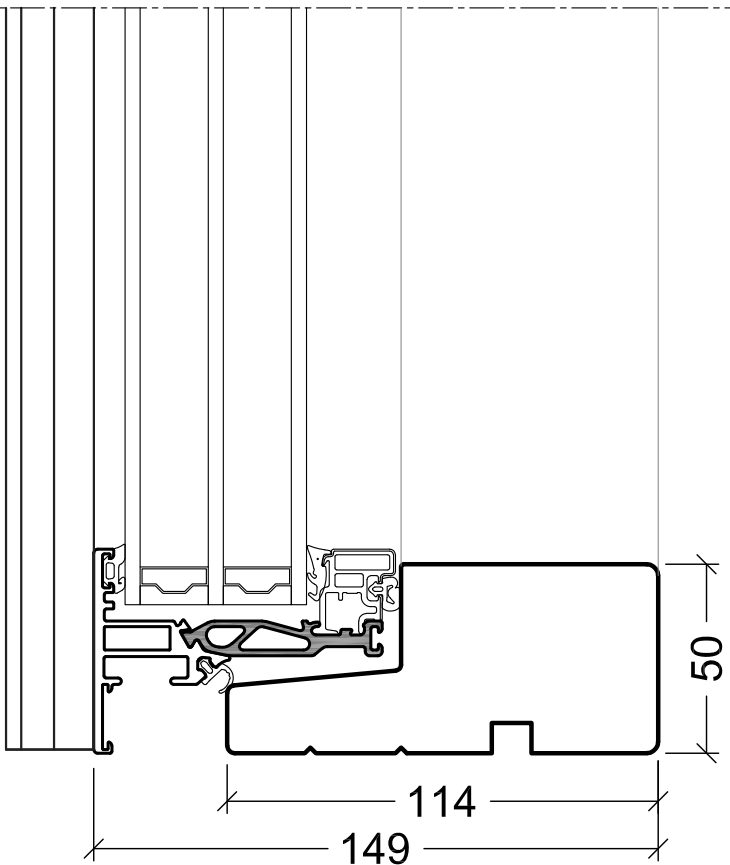

VELFAC is a trademark of DOVISTA A/S

System: VELFAC 200 Energy
English: Installation of sunlight protection
Dansk: Montage af solafskærmning

Scale: 1:2
Edition No. 03
01.21 © 2018, 2021

© DOVISTA A/S, CVR-no. 21147583. All intellectual property rights, copyright as well as all rights in know-how vest in DOVISTA A/S. This drawing may not be reproduced, stored, or transmitted in any form by any means (electronic, mechanical, photocopying, recording or otherwise) without the prior written consent of DOVISTA A/S. This drawing is to be used only for the purposes specified by DOVISTA A/S and for no other purpose. We reserve all rights to change the product and product range without notice.